

# Air Cooled Splice Press

## Safety and Operation Manual

### Quick Joint All-in-one Machine Vulcanizing Press

PA-III-900 PA-III-1200 PA-III-1500(WIFI)  
PA-III-1800(WIFI) PA-III-2100(WIFI)

  
**wifi**

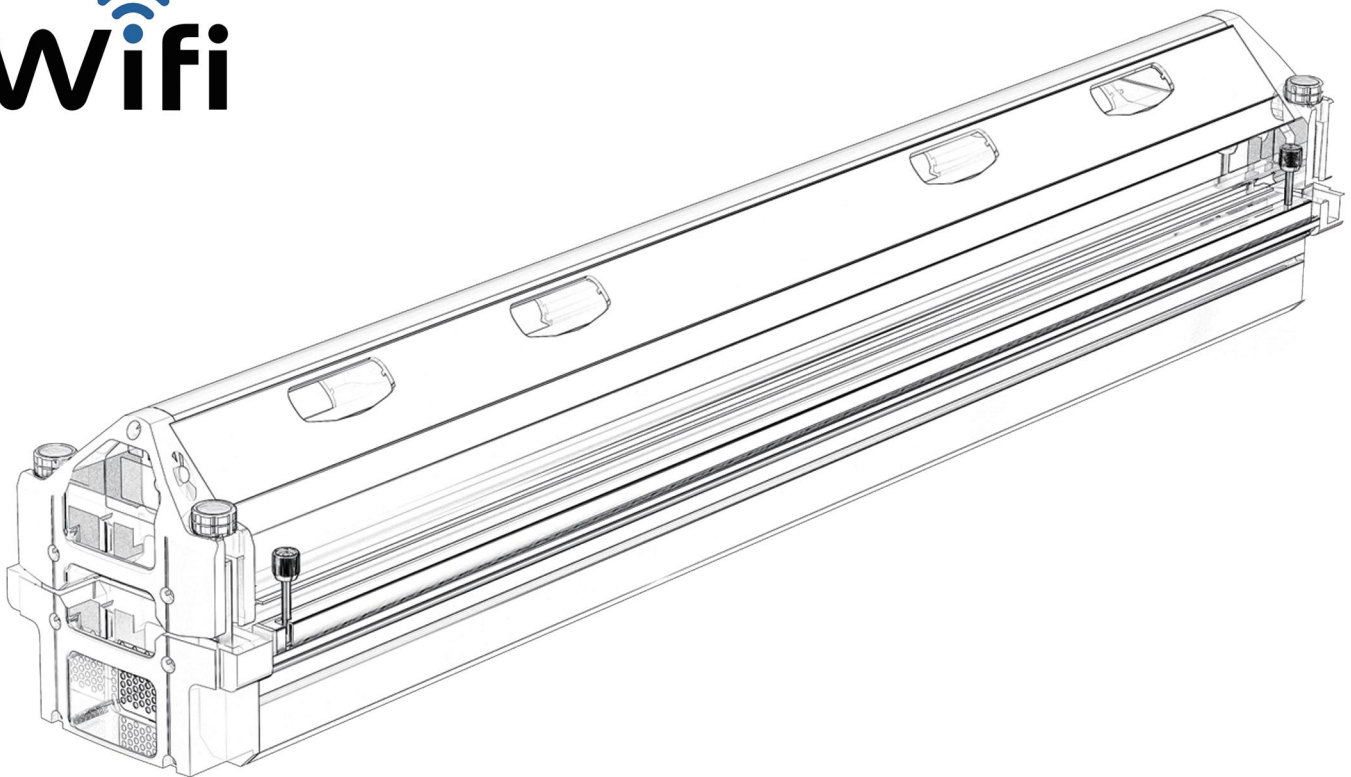

 **WARNING**

IMPROPER OR UNSAFE use of this tool can result in serious bodily injury! This manual contains important information about product function and safety. Please read and manual available for other users and owners before they use the tool. To understand this manual BEFORE operating the tool. Please keep this is manual should be stored in a safe place.

# Table of Contents

Main Components.....	pg.1
Datasheet.....	pg.2
Program 1 and 2.....	pg.2
Flight case and general safety rule.....	pg.3-4
Program 1.....	pg.5-9
Program 2.....	pg.10
WIFI (Purchase customers only).....	pg.11-12
Common problems and solutions.....	pg.13

## Quick Joint All-in-one Machine Vulcanizing Press

Be sure to read and completely understand this procedure before applying product.  
Be sure to select the proper PREFORMED product before application.

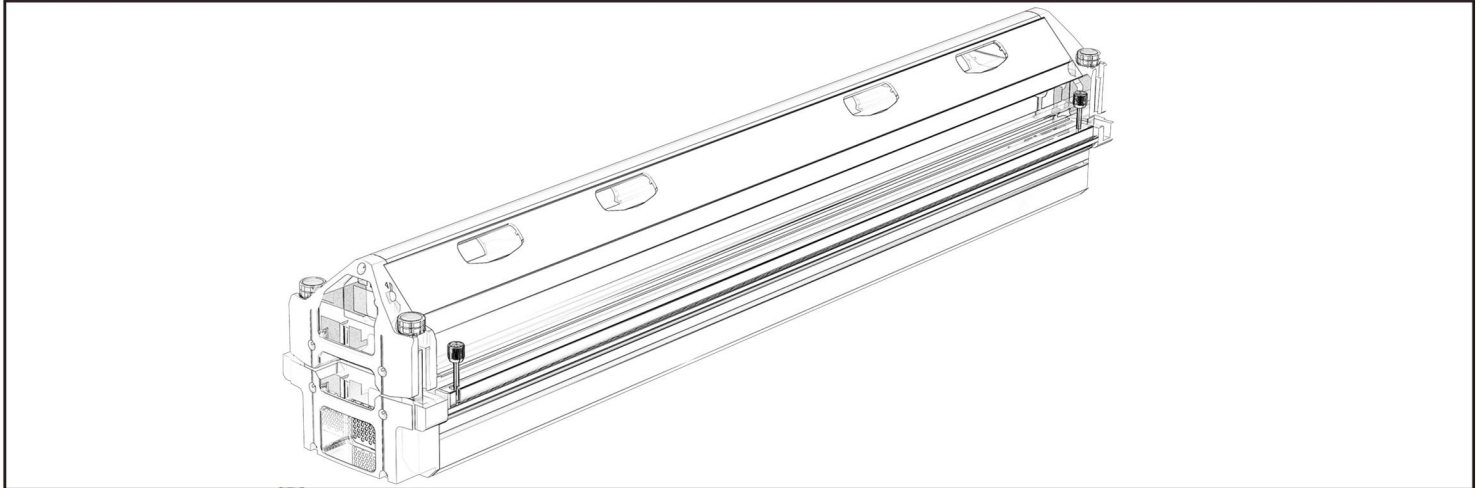

### CONSIDERATIONS:

This Application Procedure is valid for PLP Compression Splice (CMPSP) Assemblies on ACSR Conductors only.

### TOOLS SPECIFICATIONS:

1. 900mm effective(36")
2. 1200mm effective(48")
3. 1500mm effective(60")
4. 1800mm effective(72")
5. 2100mm effective(84")

### MAIN COMPONENTS

- Clamp Bar Studs & Thumbnuts
- Top Press Beam
- Handle
- Press Connector Bolts
- Clamp Bar
- Bottom Press Beam
- Start Button (green)
- Eurotherm Heat and Time Controller
- Umbilical Power Cable Connector
- Pressure Controller
- Pressure Relief Button (red)
- Main Power Cable Connector
- Function button(Silver)
- Emergency stop

### FEATURES AND BENEFITS:

The PA-III series air cooled press, have different models for width from 900 mm to 2100 mm

- 1.Used for pvc belt etc. thermoplastic belt materials portable splice press, light weight and with flight case as standard packing, is easily removed to any where for job site use
- 2.Fast splicing: include heating time and cooling time, only 9-12 mins.
- 3.All In one design: the press has an integrated air-cooling system and also air compressor inside, to ensures that the belt is quickly cooled down and auto press on, without water pump or additional air compressor.
- 4.Light weight

5.Easy to use and assemble, how to operate pls freely to refer to below video.

6.Reliable and automatic temperature control with time control (in one meter, also you can set by yourself), air pressure controller (set the air pressure and display the current pressure)

7.Voltage: 220v or 380v, if special voltage pls freely to inform us.

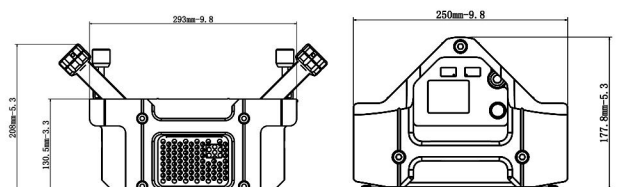

# DATASHEET AIR COOLED PRESS

Model	PA-III900	PA-III1200	PA-III1500	PA-III1800	PA-III2100
Effective length	925mm / 36"	1225 mm / 48"	1525 mm / 60"	1825 mm	2125 mm
Effective width	150mm / 5.9"	150mm / 5.9"	150mm / 5.9"	150mm / 5.9"	150mm / 5.9"
Weight upper part		28.5 kg	30 kg	63.3kg	72 kg
Weight lower part		25.5 kg	30 kg	47.5 kg	67kg
Total weight		54 kg	62 kg	121 kg	142kg
Overall Height	303 mm	303 mm	303 mm	303 mm	303 mm
width	300 mm	300 mm	300 mm	300 mm	300 mm
Length	1105 mm	1405 mm	1705 mm	2005 mm	2300 mm
Max. pressure	2 Bar / 28 PSI	2 Bar / 28 PSI	2 Bar / 28 PSI	2 Bar / 28 PSI	2 Bar / 28 PSI
Max. temperature	200 °C / 390 °F	200 °C / 390 °F	200 °C / 390 °F	200 °C / 390 °F	200 °C / 390 °F
<b>Power(仅作参考)</b>					
press+case weight					
press+case+wooden box weight			115kg	190KG	225KG
wooden box size (L*W*H)	1240*480*660	1540*480*660	1840*480*660	2140*480*660	2440*480*660

Inside to reach the required temperature. Melted material might flow away or discolor and fabrics might shrink. To avoid this problem, the preheat option can be used. This option heats the belt up (outside and inside ) to a temperature just below the melting temperature. After the preheat stage, the inside splice temperature can be reached much quicker, minimizing the risk for unwanted flow of material, discoloring or fabric shrinkage.

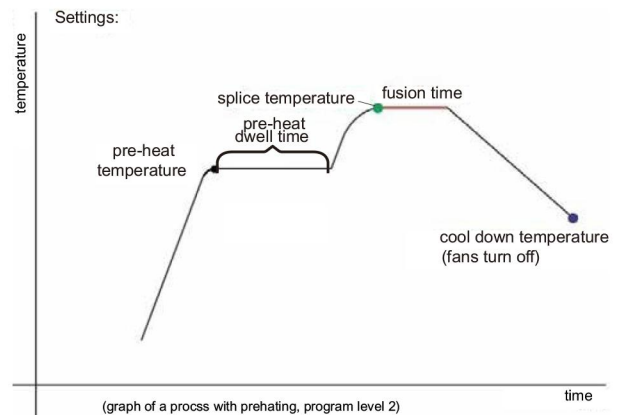
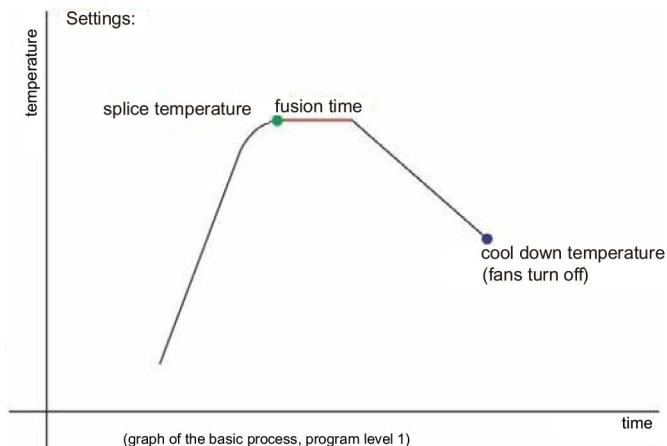

\*\* The reading of the display relates to the top temperature of the press. If more or less heat is required at the bottom of the belt, the "bottom heat factor" can be used. Please note that this factor relates to a plus or minus amount of heat (%), not to a specific temperature.



# HOLO® BELTS PRESS MACHINE

WENZHOU HONGLONG INDUSTRIAL EQUIPMENT MANUFACTURING CO.,LTD

## Flight Case

1. PA-III press are supplied with a flight case for both storage purposes and also for easy transport to on-site jobs.
2. Place press in the flight case so the end with the power receptacles is facing the storage compartment. This will protect the receptacles from damage when transporting.
3. Flight case are packaged with wheels and an extension handle.
4. Flight cases can be stacked on top of each other, but need to be secured during transportation.
5. Flight cases feature an extended handle for ease and convenience in transport. Click in the grip of the flight case to release the handle.



## General Safety Rules

[Save These Instructions](#)

### Signal words:

“DANGER” indicates an imminently hazardous situation which, if not avoided, will result in death or serious injury. The signal word is limited to the most extreme situations.

“WARNING” indicates a potentially hazardous situation which, if not avoided, could result in death or serious injury.

“CAUTION” indicates a potentially hazardous situation which, if not avoided, may result in minor or moderate injury. It may also be used to alert against unsafe practices.

### Safety Symbol



This international safety symbol is used to identify and call attention to specific safety matters.

### Safety Information

To Avoid Severe Personal Injury or Property Damage, read carefully and understand the following Safety Precautions.

### Overall Safety rules

**⚠ DANGER**

To Avoid Severe Personal Injury or Property Damage, read carefully and understand the following Safety Precautions.

**⚠ DANGER**

Terminate electrical hazards by removing power cord from wall receptacle or machine base inlet.

**⚠ WARNING**

Terminate pressure related hazards by pressing the red pressure relief button.

**⚠ CAUTION**

Press platens develop over 5 tons of clamping force. When operating the press keep the four press connector bolts in place by hand tightening.

**⚠ CAUTION**

Avoid temperature related hazards by handling press components and belt once safely cooled.

# HOLO<sup>®</sup> BELTS PRESS MACHINE

WENZHOU HONGLONG INDUSTRIAL EQUIPMENT MANUFACTURING CO.,LTD

## MATTERS OF PARTICULAR

This manual will be referred to the key components of the following, if failed to account for the location, please refer to the map to understand.

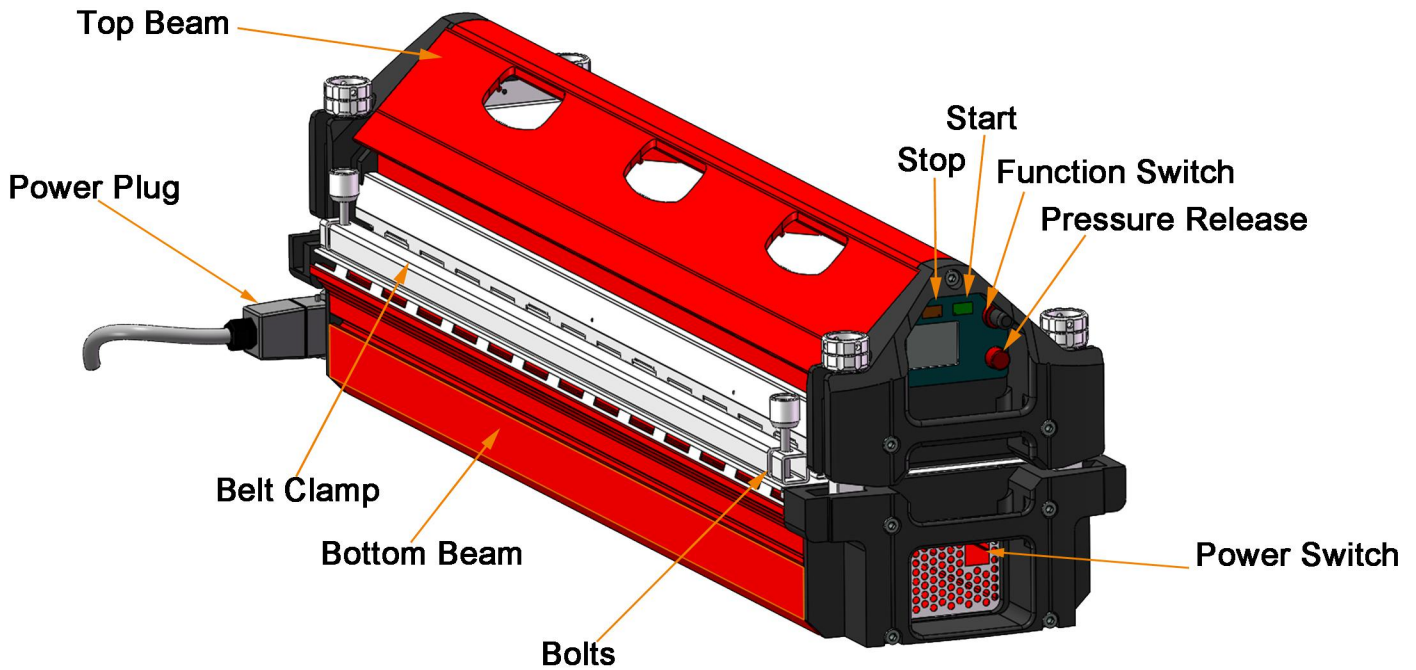

## UNLOCK AND OPEN

Open the box and carried out the simple steps of the machine, the machine weight of different length is different, need two or more people to pay attention to the bottom of the box out, locking universal wheel when in operation

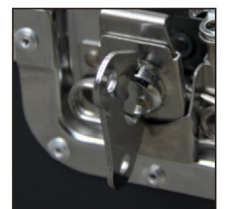
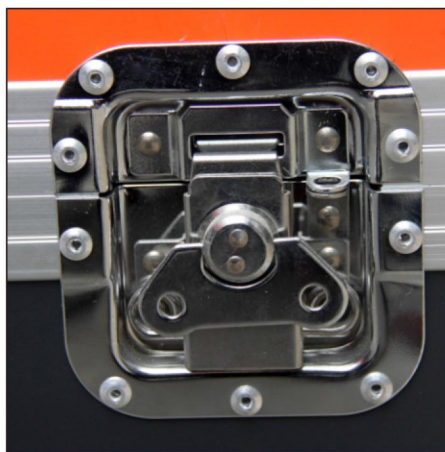



# HOLO<sup>®</sup> BELTS PRESS MACHINE

WENZHOU HOLO INDUSTRIAL EQUIPMENT MANUFACTURING CO.,LTD

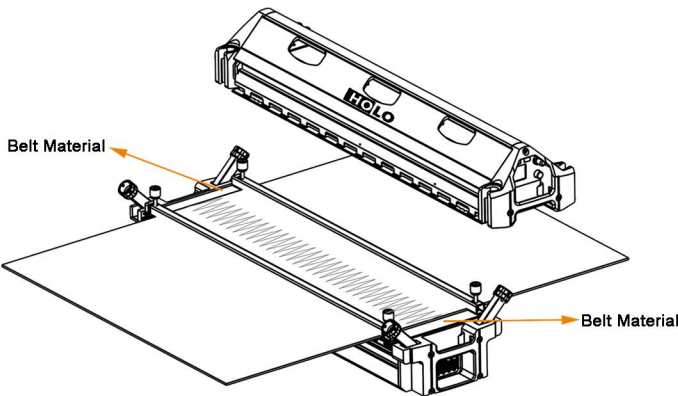

1. Put the Belt and belt material onto the machine bottom plate.

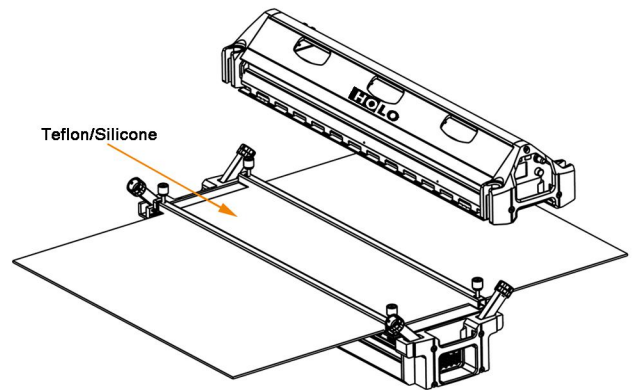

2. Put the teflon onto the Belt

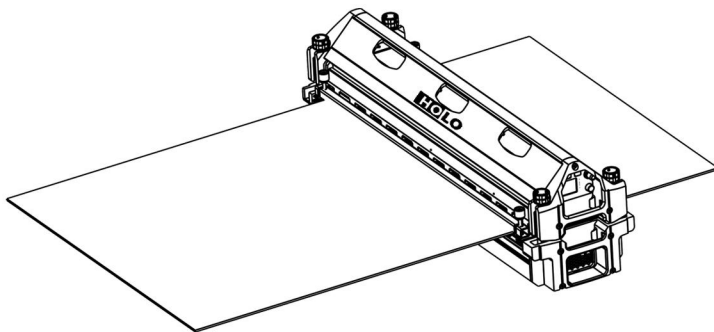

3. Cover the top beam and lock it by 4pcs bolts.

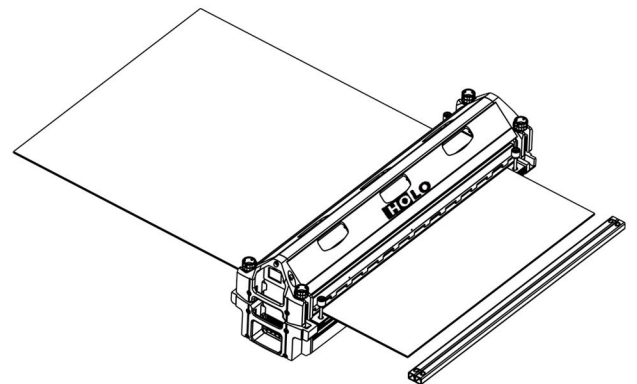

4. Suggestion: Take off the clamp after pressed the start button. (Protect the clamp).

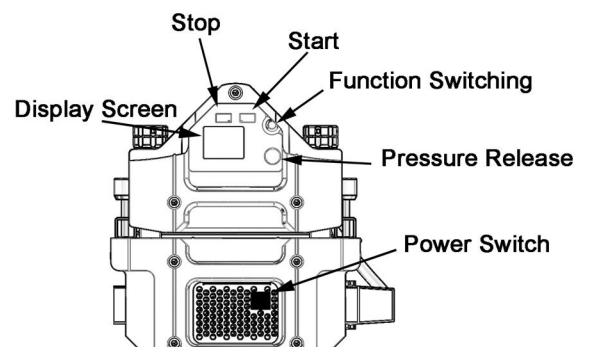
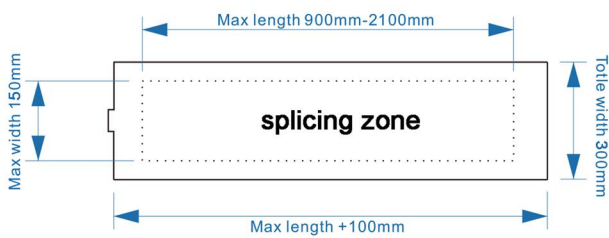

# HOLO<sup>®</sup> BELTS PRESS MACHINE

WENZHOU HONGLONG INDUSTRIAL EQUIPMENT MANUFACTURING CO.,LTD

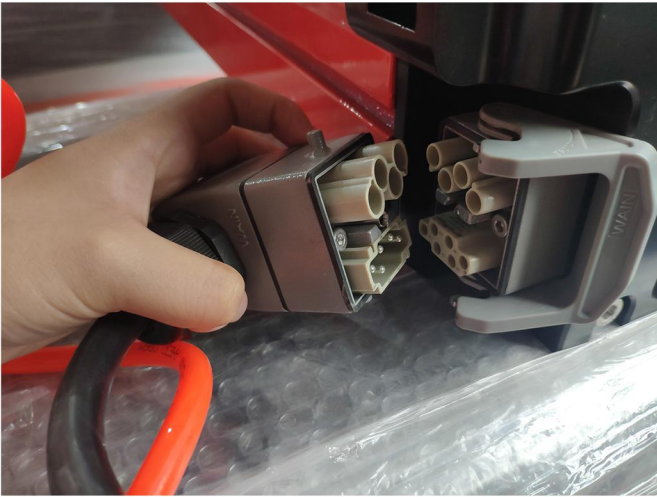

6. Connect the Upper and lower beam connection wire.



7. Connect the power wire.

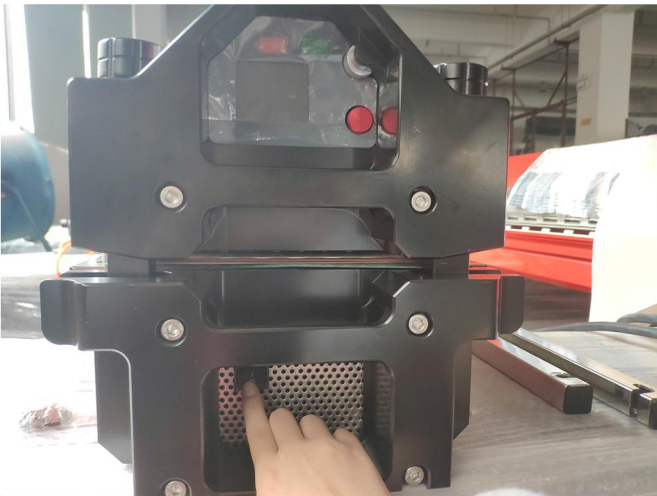

8. Open the main power.

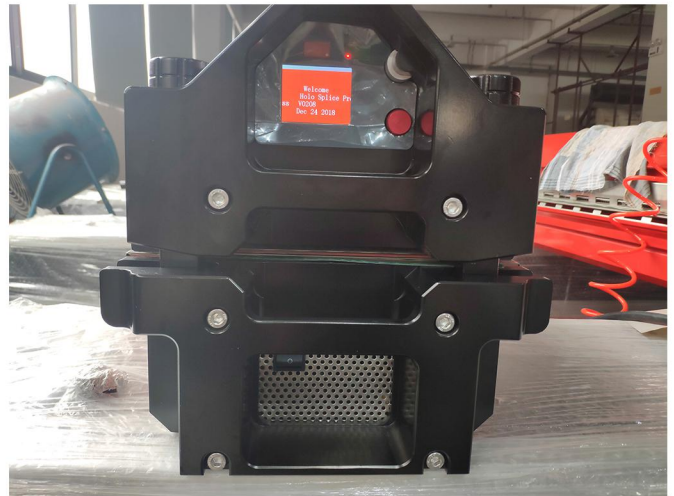

9. Welcome to use HOLO Press

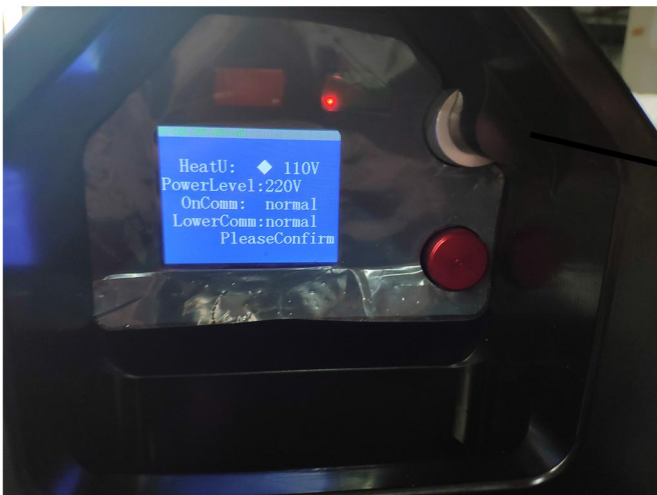

10. Check and Confirm the power

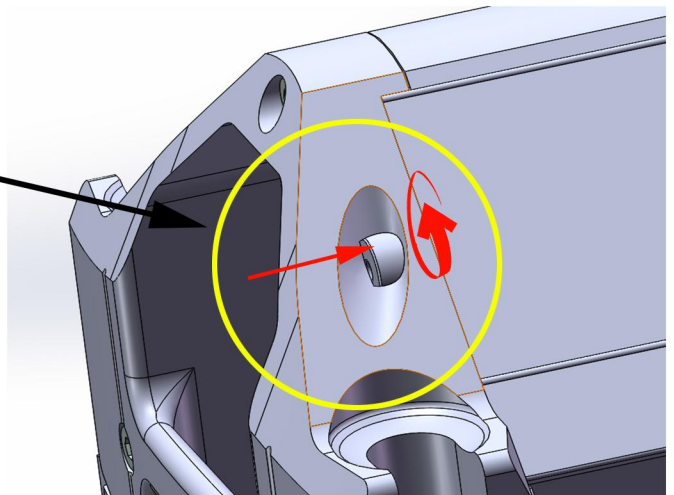

11. Press the button to Confirm/Back/Set  
Rotation is to select the option



# HOLO® BELTS PRESS MACHINE

WENZHOU HOLO INDUSTRIAL EQUIPMENT MANUFACTURING CO.,LTD



12. Stand by



13. Press the function button to Set interface

## Function Option:

### 1) Pressure

a. Pressure: 1.0 Bar

### 2) TopTemp (Top beam Splice Temperature)

a. Top Temp : ???°C

### 3) BottomTemp (Bottom beam Splice Temperature)

a. Bottom Temp: ???°C

### 4) SwitchPreHeat (Switch for pre-heat system)

a. SwitchPreHeat: ON

Preheat Temp: ???°C

Preheat DwellT (Preheat Dwell Time): ??M??S

b. Switchpreheat: OFF

### 5) SplicedwellT (Splice Dwell Time)

a. SplicedwellT: ??M??S

### 6) CoolTemp (Cooling Temperature)

a. CoolTemp: ???°C

### 7) Options

a. PressureADJ (Do not adjust this, it is for inspection and repair)

b. SoundSW (ON/OFF)

c. Language: (Chinese/English)

### 8) Back



14.Set up pressure and confirm

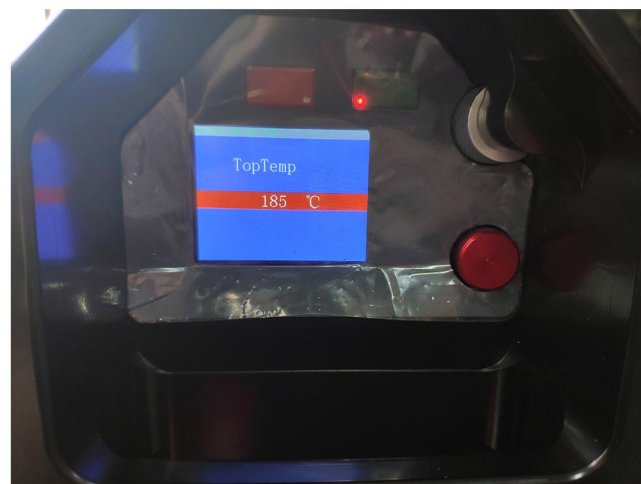

15.Set up TopTemp

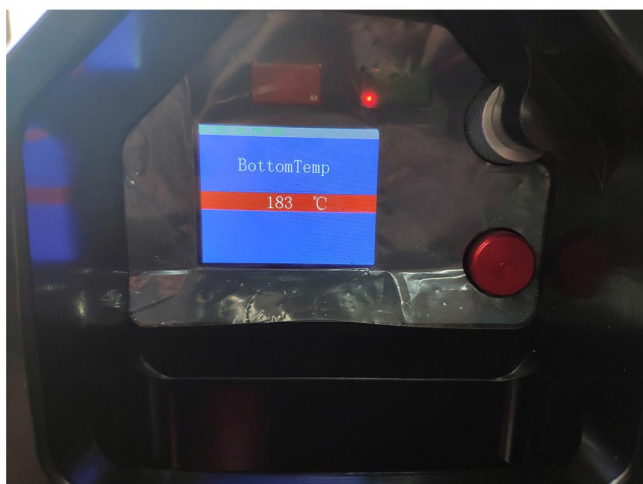

16.Set up bottomTemp



17.Set up CoolTemp

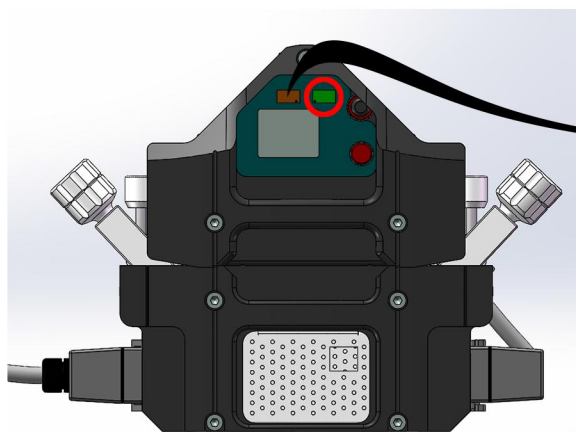

Problems happened,press the Red button for emergency stop.

18.Press the Green button to start.



# HOLO® BELTS PRESS MACHINE

WENZHOU HONGLONG INDUSTRIAL EQUIPMENT MANUFACTURING CO.,LTD



19. Automatic Joint



20. Running Time

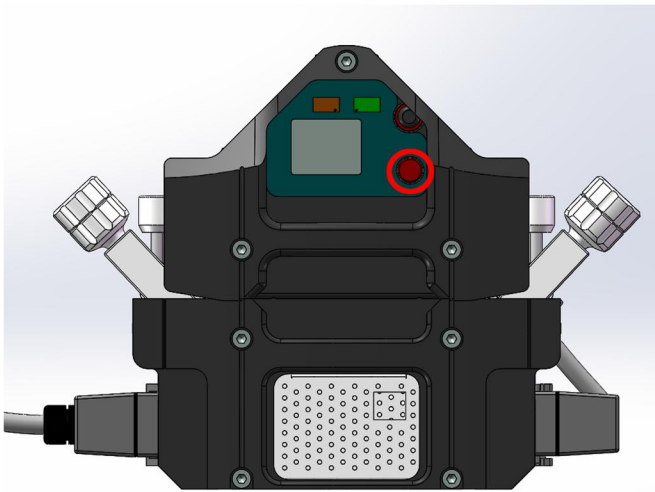

21. Release the pressure by Red round-button

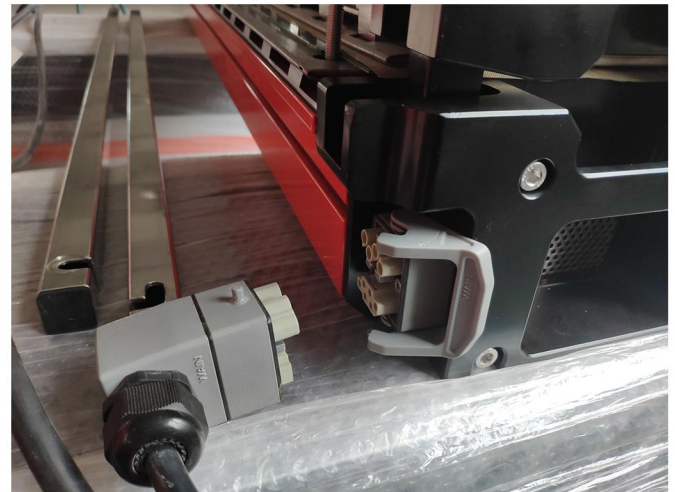

22. After joint Completed, plug off the Upper and lower beam connection.

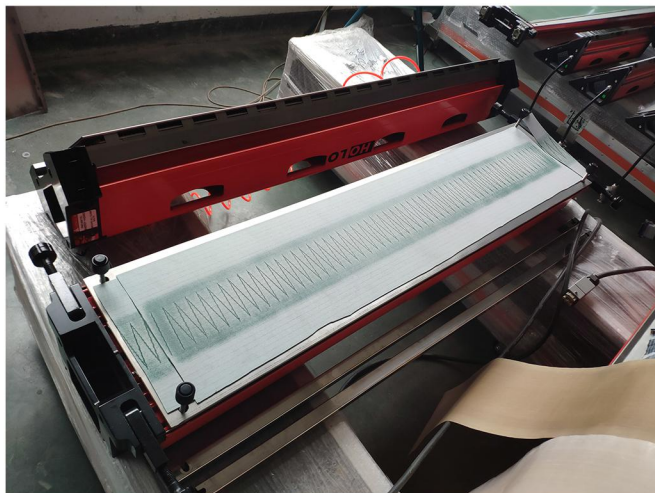

23. Check the joint quality





## Pre-heating System

If belt is relatively thick, a problem might occur where the outside of the belt is at the splicing temperature too long, waiting for the inside to reach the required temperature. Melted material might flow away or discolor and fabrics might shrink. To avoid this problem, the preheat option can be used. This option heats the belt up (outside and inside) to a temperature just below the melting temperature. After the preheat stage, the inside splice temperature can be reached much quicker, minimizing the risk for unwanted flow of material, discoloring or shrinkage.

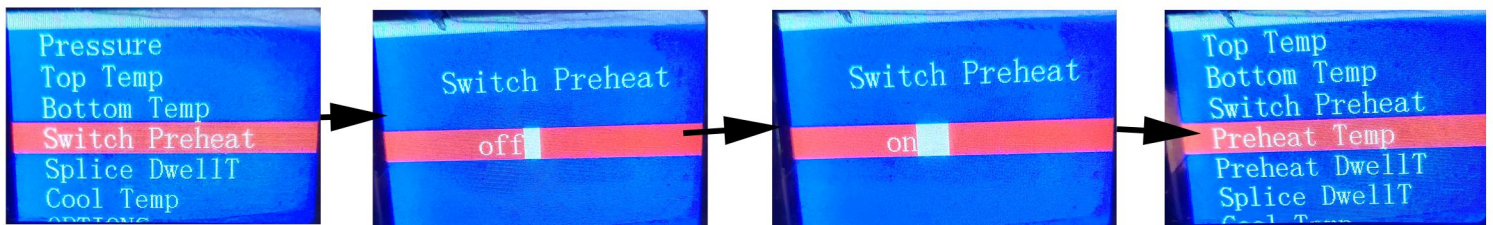
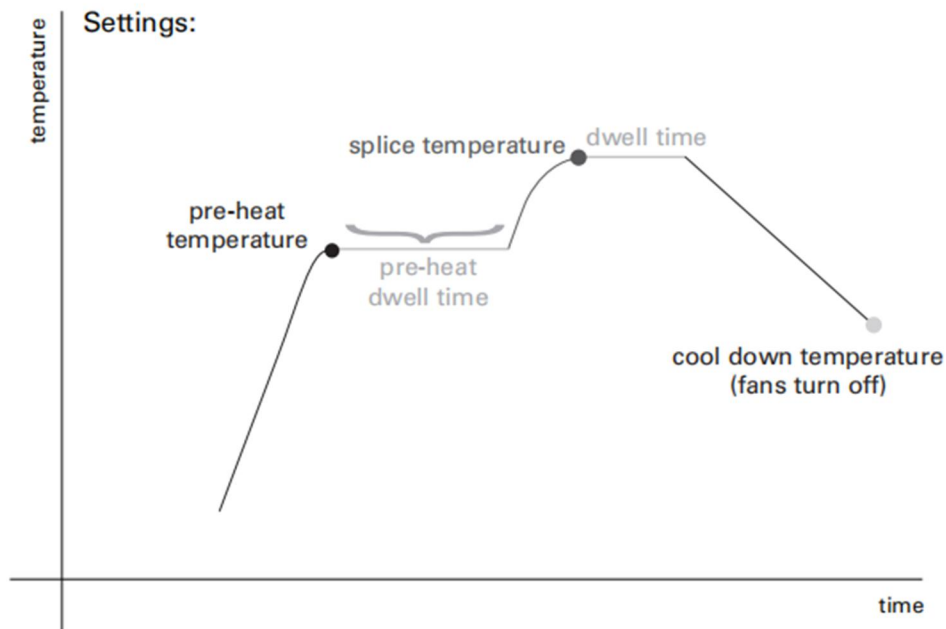

Turn on the Preheat Switch,  
There will be two options (Preheat Temp and Preheat DwellIT),set it up.

---

**HOLO® BELTS PRESS MACHINE**WENZHOU HONGLONG INDUSTRIAL EQUIPMENT MANUFACTURING CO.,LTD

---

**Common problems and solutions**

NO.	Description	Photo	

## SAFETY CONSIDERATIONS

This application procedure is not intended to supersede any company construction or safety standards. This procedure is offered only to illustrate safe application for the individual. FAILURE TO FOLLOW THESE PROCEDURES MAY RESULT IN PERSONAL INJURY OR DEATH.

Do not modify this product under any circumstances.

This product is intended for use by trained technicians only. This product should not be used by anyone who is not familiar with, and not trained to use it.

When working in the area of energized lines, extra care should be taken to prevent accidental electrical contact.

For proper performance and personal safety, be sure to select the proper size PREFORMED product before application.

PREFORMED products are precision devices. To insure proper performance, they should be stored in cartons under cover and handled carefully.



# HOLO BELTS PRESS MACHINE

**HOLO**



Factory scene

© **Wenzhou Honglong Industrial Equipment Manufacturing Co., Ltd**

Room 201, Building 3, NO.188 Wangxin Road Dongshan Street RUIAN Wenzhou

ZHEJIANG, China

Web: <http://www.holobelt.com>

Tel:(86)0577 65682000 Fax:(86)0577 65916651